



# Lot Grading Permit Application

Inspection & Elevation Plan

Subject to By-Law No. 10-2004

Town of Morden

100-195 Stephen Street

Morden, MB R6M 1V3

Application Date: \_\_\_\_\_ Civic Address: \_\_\_\_\_

Application Number: \_\_\_\_\_ Lot \_\_\_\_\_ Block \_\_\_\_\_ Plan \_\_\_\_\_

Property Owner: \_\_\_\_\_ Phone: \_\_\_\_\_

Address: \_\_\_\_\_

Contractor: \_\_\_\_\_ Phone: \_\_\_\_\_

Benchmark Elev \_\_\_\_\_

Bench. Description \_\_\_\_\_

Comments/Notes: \_\_\_\_\_

### Legend:

- Existing Elev
- Design Elev
- As-Built Elev
- Curb Elev

Drainage Pattern:  Front-Back  Back-Front  Split

Property Plan (Not to Scale):

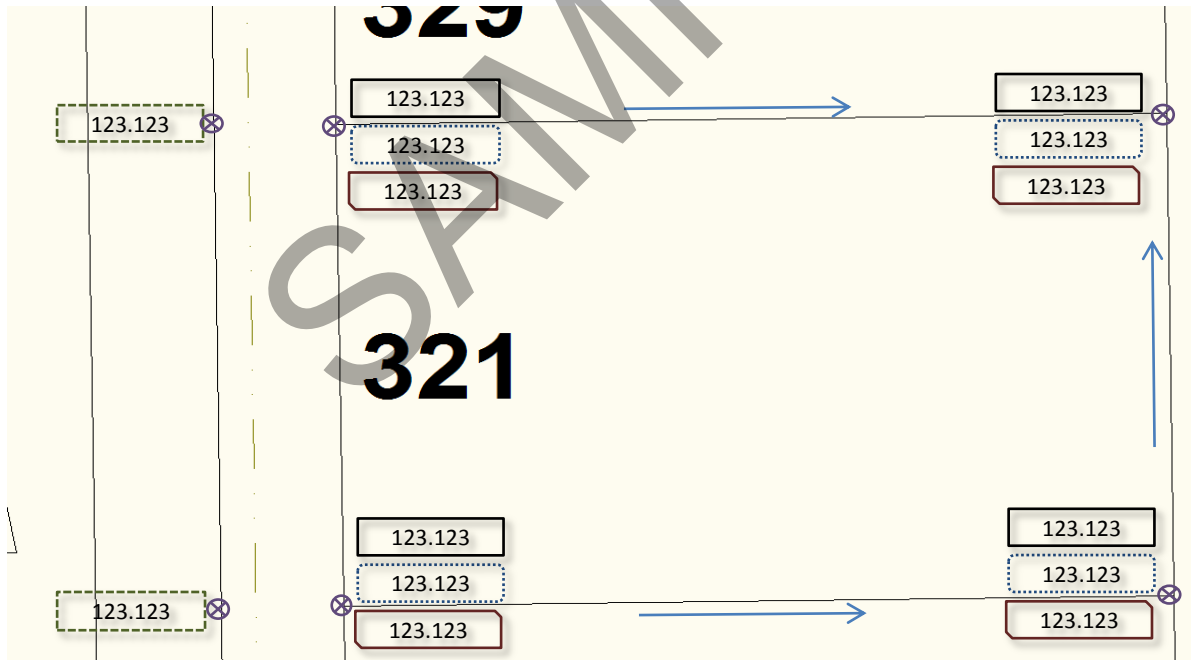

I certify that the as-built elevations shown on this permit were verified on the date indicated and that I am authorized to conduct this inspection:

Final Inspection Date \_\_\_\_\_

Inspection Result \_\_\_\_\_

Refund Deposit \_\_\_\_\_

Additional Charges \$ \_\_\_\_\_

Name: \_\_\_\_\_

Company: \_\_\_\_\_

Signature: \_\_\_\_\_